

LED Ground Bunied Light

Model : GB-0618-H108G

Features:



Lighting Source



Model:GB-0618-H108G

Standard

Standard Size(mm)	Ø220mm
Hole Size	200mm
Voltage (V)	AC85~265V
Beam Angle	90 degree
CRI	>80Ra
Luminous Efficacy	100 lm/w
Power Factor	> 0.92
Power (W)	18W
Cover Material	Stainless+Explosion-proof glass
Color Temperature	2700K-6500K
Life Time	50,000(H)
IP Grade	IP 65

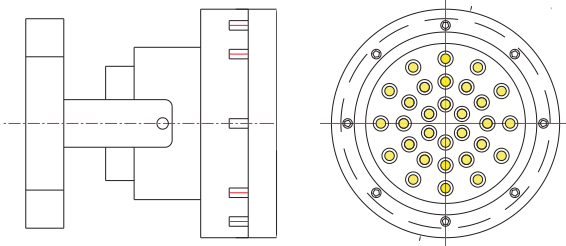

LED Ground Bunied Light

Model : GB-0620-H108E

Features:



Lighting Source



Model:GB-0620-H108E

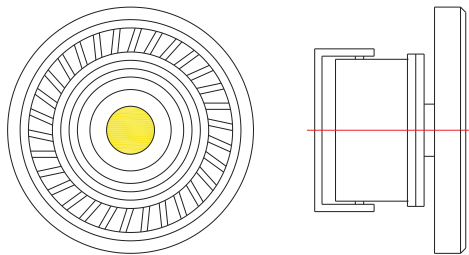

Standard

Standard Size(mm)	Ø220mm
Hole Size	180mm
Voltage (V)	AC85~265V
Beam Angle	90 degree
CRI	>80Ra
Luminous Efficacy	100 lm/w
Power Factor	> 0.92
Power (W)	20W
Cover Material	Stainless+Explosion-proof glass
Color Temperature	2700K-6500K
Life Time	50,000(H)
IP Grade	IP 65

LED Ground Bunied Light

Model : GB-0812-H108E

Features:



Lighting Source



Model:GB-0812-H108E

Standard

Standard Size(mm)	Ø210*95mm
Hole Size	200mm
Voltage (V)	AC85~265V
Beam Angle	30 degree
CRI	>80Ra
Luminous Efficacy	100 lm/w
Power Factor	> 0.92
Power (W)	12W
Cover Material	Stainless+Explosion-proof glass
Color Temperature	2700K-6500K
Life Time	50,000(H)
IP Grade	IP 65

